

UX series solar inverters

autarco

The new Autarco three-phase UX series inverters offer the best and most reliable performance in its class. With four independent MPPTs and a total of 12 string inputs, they offer the flexibility often asked in for commercial rooftop solar projects, managing shade losses from obstacles and environment. This serie is designed to offer the best possible business case without saving on essential functionalities.



Eligible for Autarco's insured kWh Guarantee



Compact, lightweight



Max efficiency of 99%



High speed MPPT algorithm



Cloud-based digital O&M



QUALITY CERTIFICATES

- ◆ EN 50438 IE, VDE0126-1-1, G59/3, NB/T32004, AS4777, IEC61727 IEC62109-1-2, AS3100, EN61000-6-1, EN62109
- ◆ VDE4105, CE, Solarif



GENERAL CHARACTERISTICS

Dimensions (W x H x D)	630 x 700 x 357mm
Mounting	Wall bracket
Max. site altitude	4000m
IP protection class	IP65 according IEC 60529
Isolation type	Transformerless
Cooling principle	Convection with smart fan-cooling
Noise level, typical	< 30dBA, <50dBA with cooling fan
DC connection type	Stäubli MC4
LCD display	20 x 2 characters
Communication interfaces	1xRS485, 2xRJ45
Optional interfaces	WiFi, GPRS, Z-Wave, LAN
DC switch	Integrated (optionally excluded)

Front

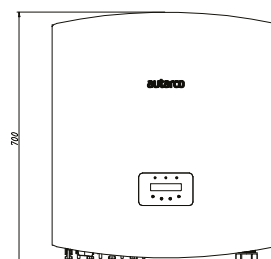

Side

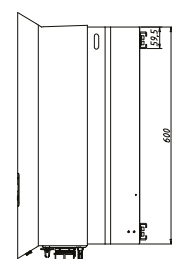

Bottom

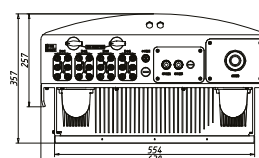

Bracket

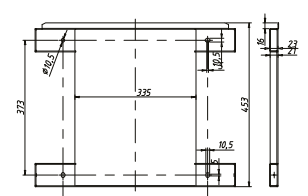

INPUT CHARACTERISTICS

	S2.UX4000(S)	S2.UX5000(S)	S2.UX6000(S)	S2.UX7000(S)-HV
Max. PV input power (W)	48000	60000	72000	84000
Max. DC voltage (V)	1100	1100	1100	1100
MPP tracker voltage range (V)	200-1000	200-1000	200-1000	200-1000
Start-up DC voltage (V)	200	200	200	200
Number of MPP trackers	4	4	4	4
Max. DC current per MPPT (A)	22.0	28.5	28.5	28.5
Number of DC connections per MPPT	2	3	3	3
Max. short circuit current (Isc) per MPPT (A)	34.3	44.5	44.5	44.5
Turn on power (W)	10	10	10	10

OUTPUT CHARACTERISTICS

AC connection	380 / 400 VAC	380 / 400 VAC	380 / 400 VAC	540 VAC
Power connection	3-phase	3-phase	3-phase	3-phase
Rated AC power (W)	40000	50000	60000	70000
Max. AC power (W)	44000	55000	66000	77000
Grid voltage range (V)	Conform VDE 0126-1-1, G59/3, AS4777, NB/T32004			
Grid frequency range (Hz)	Conform VDE 0126-1-1, G59/3, AS4777, NB/T32004			
Rated AC current (A)	58.0	72.2	86.6	84.2
Max. AC current (A)	66.9	83.3	100.0	92.6
Power factor	0.8...1...0.8	0.8...1...0.8	0.8...1...0.8	0.8...1...0.8
Harmonic distortion (%)	< 2	< 2	< 3	< 3
Cooling principle	Convection	Cooling fan	Cooling fan	Cooling fan
DC injection current (mA)	< 50	< 50	< 50	< 50
Weight (kg)	61	63	63	63

EFFICIENCY

Max. efficiency	98.80% - 99.00%
Euro efficiency	98.40% - 98.50%
MPPT efficiency	>99.90%

PROTECTION

DC overvoltage protection	Integrated
DC reverse polarity protection	Integrated
Short circuit protection	Integrated
Grid monitoring	Integrated
Residual current detection	Integrated
Insulation resistance monitoring	Integrated
Temperature protection	Integrated
Islanding protection	Integrated
Arc-fault circuit interrupter	Optional

OTHER CHARACTERISTICS

Operating temperature range	-25°C to +60°C
Relative humidity range	0% to 100%

The specifications contained in this datasheet may deviate slightly from our actual products due to on-going product improvement and are subject to change at any time without prior notice.

